



Ringshall Parish Clerk &lt;pc.ringshall@gmail.com&gt;

**Kompan - Ringshall Play Area**

1 message

**Helen Sephton-Pike** <HelSep@kompan.com>

To: Ringshall Parish Clerk &lt;pc.ringshall@gmail.com&gt;

Wed, May 3, 2023 at 11:29 AM

Hi Lacey, apologies for my delayed response, I'm just back today from annual leave.

With regards to the plank bridge, I'm sorry we can't add anything to it without effecting the standards it adheres to. It is designed to be wobbly with movement when children use it, It's not un-safe if used appropriately by the target age range of 4 upwards. Some elements of the unit are designed for ages 6 upwards for example the overhead ladders. But overall, the unit is designed to be challenging with graduated risk experiences for children to learn and practice their skills of balance and co-ordination.

I have attached a plan of the play area for you, showing 3 x yellow stars where it may appear there is space for an additional springer, however one is directly next to the dynamic overhead bars for older children so this is not a safe place to put a springer, another star is shown at the end of one of the slides, again its not safe to put it here and lastly there is a space in the corner by the roundabout, but unfortunately it wont be possible here either as you have to walk directly through the roundabout zone to get to it.

The only place I can see is maybe right next to the existing springer shown with a red star (subject to the plan matching what is actually on site) to check if there is enough space I have asked one of our design team to have a look for us and I will come back to you as soon as I can.

Best Regards

Helen Sephton-Pike

07764365669

**Kompan Ltd.**

Serenity House

Shirwell Crescent

Furzton Lake

Milton Keynes MK4 1GA

United Kingdom

Let's play at [Kompan.uk](https://www.kompan.uk) | [LinkedIn](#) | [Facebook](#) | [Twitter](#)



Ringshall Parish Clerk &lt;pc.ringshall@gmail.com&gt;

**RE: Kompan - Ringshall Play Area**

1 message

Helen Sephton-Pike <HelSep@kompan.com>  
To: Ringshall Parish Clerk <pc.ringshall@gmail.com>

Thu, May 11, 2023 at 3:22 PM

Hi Lacey,

Following on from my email below, an additional springie may fit in, see image below. It is tight and to make 100% sure I would need to come over and measure exactly where the new unit sits in comparison to the existing Springie and the fence.

Let me know if you'd like me to do that and I will diary a visit.

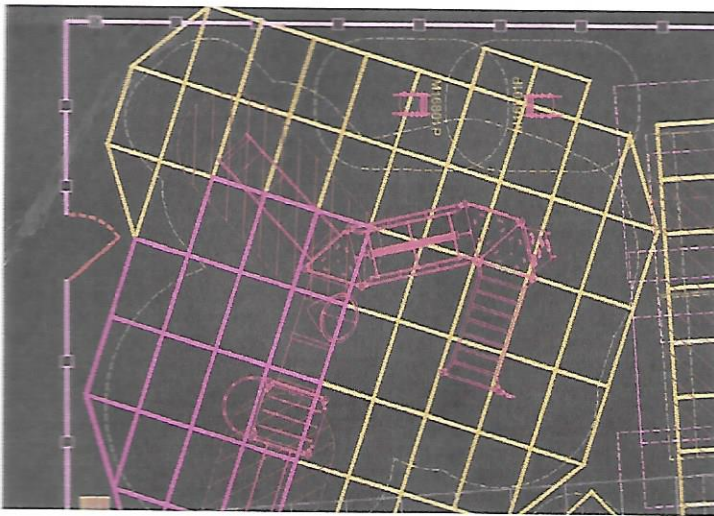

Best Regards

Helen Sephton-Pike

07764365669

**Kompan Ltd.**

Serenity House

Shirwell Crescent

Furzton Lake

Milton Keynes MK4 1GA

United Kingdom



Let's play at [Kompan.uk](http://Kompan.uk) | [LinkedIn](#) | [Facebook](#) | [Twitter](#)